

Time : 6 Hrs.

D1G
W/S (Pr.)

Full Marks : 80

Pass Marks : 32

1. Each question carries equal marks.
iR; d i l u dk eku cjkj gA
2. Examiners will allot **any one** job from the undermentioned jobs to the examinee / group of examinees by lottery to prepare the job according to the question.
i j h { k d f u E u k f d r t k l e e a l s f d l h , d t k l e d k v k o d / u i j h { k k f k h z @ i j h { k k f f k z k a d s l e g d k s Y k k W j h } k j k d j a s , o a i l u & i = d s v u d k j t k l e d k s r s k j d j u s d k f u n z k n a A
3. Marks are to be distributed (to the best possible) in the following orders :
v a d k s d k f o r j . k 1/4; F k k l k o 1/2 f u E u c d k j f d ; k t k ; %
- | | <u>Intrn.</u> | <u>Extn.</u> |
|---|---------------|--------------|
| | <u>Comm.</u> | <u>Comm.</u> |
| (a) Practical exercise book
o x l e a f d ; s x ; s t k l e d k ; l d h i q l r d k | 10 | 10 |
| (b) Methodology of job preparation
t k l e r s k j d j u s d h f o f / k & f o o j . k | 20 | 30 |
| (c) Viva voce
e k f [k d c ' u | 10 | |

1. Prepare a suitable pulse mixer with a handle 400 mm long from the given wood pieces in your carpentry shop.

vi uh dk"B dk; Zkkyk ea 400 feiehi gMY okyh , d nky?kk/uh nh x; h ydMh ds VpMka l sr\$ kj djA

2. Prepare a Male-Female joint as in figure-1.

fp= l E&1 ds vuq kj esy&fQesy tkM+r\$ kj djA

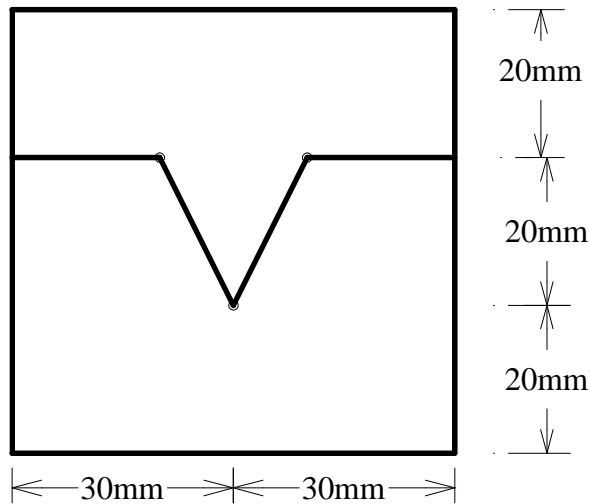

Fig. -1

3. Prepare a Ring having mean dia 50 mm from a 8 mm M.S. Rod Piece in your Blacksmithy shop.

vi uh yk\$ dk; Zkkyk ea 8 fe-eh- 0; kl ds enq bLl kr NM+ l s 50 fe-eh- ekè; 0; kl dk fja r\$ kj djA

4. Prepare a job as in fig. 2 in your welding shop.

fp= l E&2 ds vuq kj vi uh ofYM/x dk; Zkkyk ea , d tkt r\$ kj djA

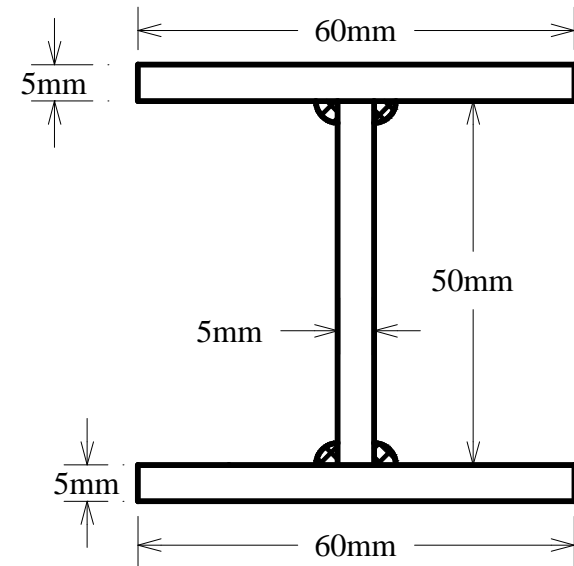

Fig. -2

5. Prepare a 200 mm x 200 mm x 20 mm metal sheet tray
in your sheet metal shop.

vi uh BBjh dk; Zkkyk ea200 fe-eh x 200 fe-eh x 20 fe-eh eki

dh ,d V\$ r\$ kj djA

